

SERVICE PLUG GRIP

21041-01

Removal & Installation and Disassembly & Reassembly

NOTICE:

- When working on the high voltage systems, always wear insulating gloves.
- After removing the service plug grip, do not operate the power switch as it may damage the hybrid vehicle control ECU.
- Keep the removed service plug in your pocket to prevent other technicians from reconnecting it while you are servicing the vehicle.
- After removing the service plug grip, do not touch the high voltage connectors and terminals for 5 minutes.

1. PRECAUTION (See page 21-7)

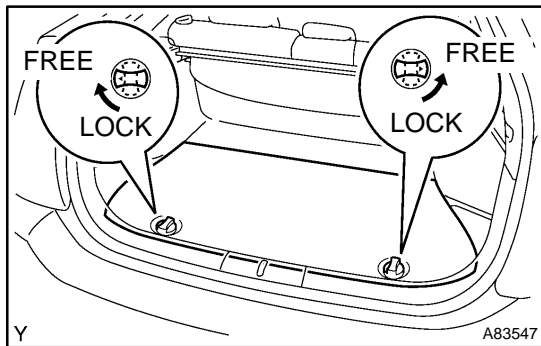

2. REMOVE REAR FLOOR BOARD NO.2

- As shown in the illustration, twist the knob and release the lock.
- Remove the rear floor board No. 2.

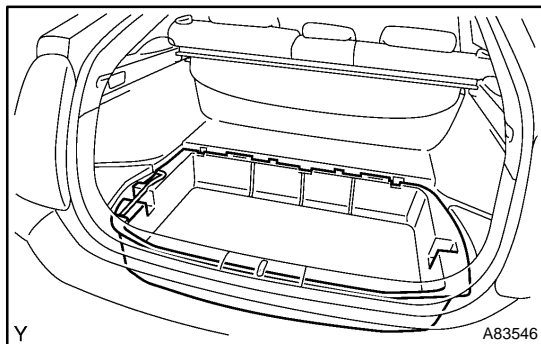

3. REMOVE DECK FLOOR BOX REAR

- Remove the deck floor box rear as shown in the illustration.

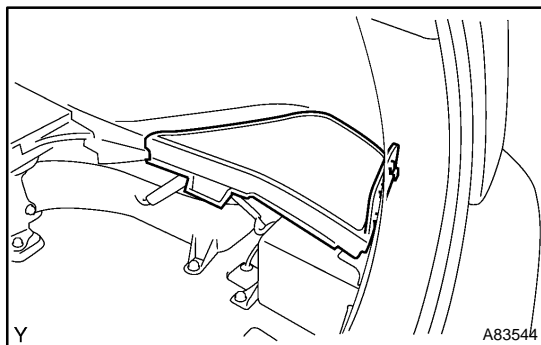

4. REMOVE REAR FLOOR BOARD NO.3

- Remove the rear floor board No. 3 as shown in the illustration.

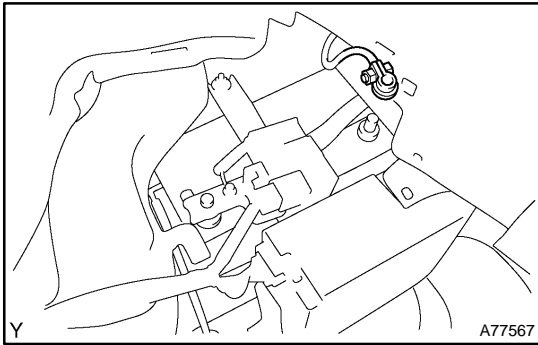

5. DISCONNECT BATTERY NEGATIVE TERMINAL

- (a) Disconnect the negative terminal of the 12 V auxiliary battery.

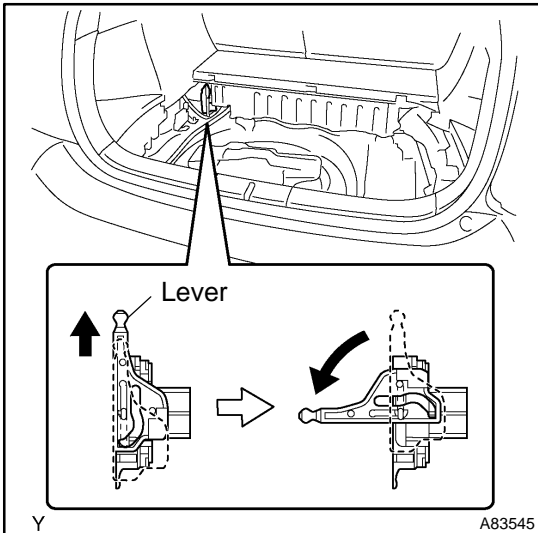

6. REMOVE SERVICE PLUG GRIP

NOTICE:

Wear insulating gloves.

- (a) Slide up the lever of the service plug grip. Remove the service plug grip while turning the lever to the left.
 (b) Insulate the service plug with insulating tape.

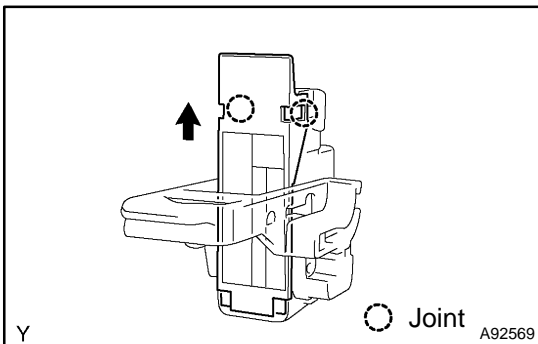

7. REMOVE ELECTRIC VEHICLE FUSE

- (a) Remove the 2 joints shown in the illustration, then remove the service plug grip cover.

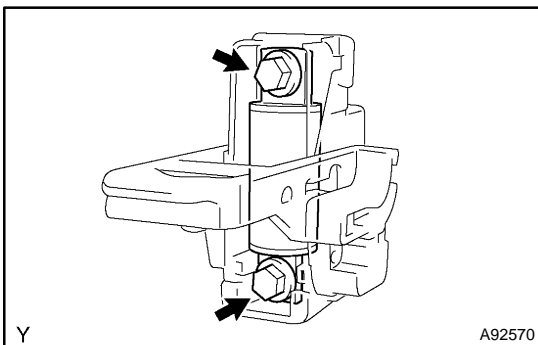

- (b) Remove the 2 bolts and electric vehicle fuse.

8. INSTALL ELECTRIC VEHICLE FUSE

- (a) Install the electric vehicle fuse with the 2 bolts.
Torque: 5.4 N·m (55 kgf·cm, 48 in·lbf)
 (b) Fit the 2 joints, then install the service plug grip cover.

9. INSTALL SERVICE PLUG GRIP**NOTICE:****Wear insulating gloves.**

- (a) Joint the service plug grip with the HV battery.
- (b) While pushing the service plug grip to the right, rotate the lever to the right.
- (c) Be sure to slide the lever down to lock the service plug grip in place.

NOTICE:

- The service plug grip must be locked. If not, it may cause DTCs to output.
- Do not operate the power switch when the service plug grip is not properly locked. It may damage the hybrid vehicle control ECU in rare cases.

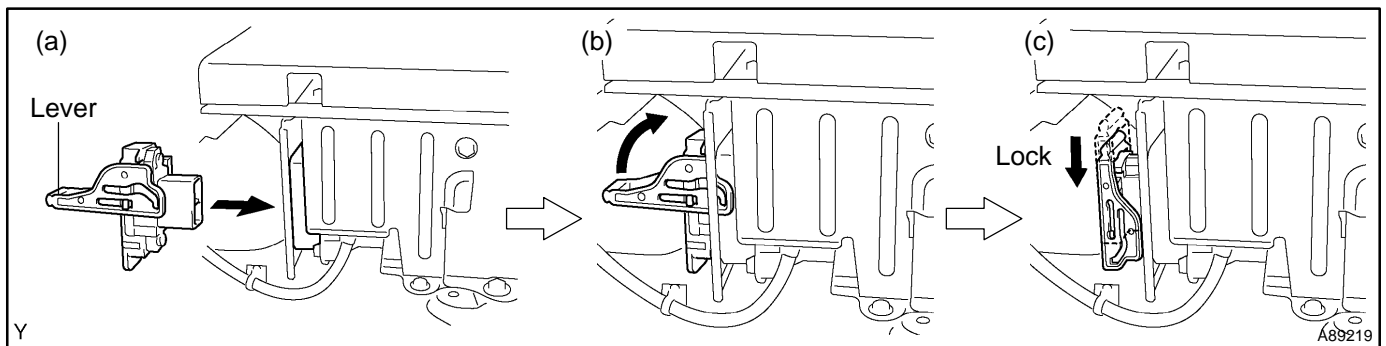
**10. CONNECT BATTERY NEGATIVE TERMINAL**

Torque: 6.0 N·m (61 kgf·cm, 53 in·lbf)

11. INSTALL REAR FLOOR BOARD NO.3**12. INSTALL DECK FLOOR BOX REAR****13. INSTALL REAR FLOOR BOARD NO.2****14. POWER WINDOW CONTROL SYSTEM INITIALIZE (See page 01-28)**