

## REPLACEMENT

1. REMOVE FR WIPER ARM LH (SEE PAGE 66-14)
2. REMOVE FR WIPER ARM RH (SEE PAGE 66-14)
3. REMOVE HOOD TO COWL TOP SEAL (SEE PAGE 66-14)
4. REMOVE COWL TOP VENTILATOR LOUVER LH (SEE PAGE 66-14)
5. REMOVE COWL TOP VENTILATOR LOUVER RH (SEE PAGE 66-14)
6. REMOVE WINDSHIELD WIPER MOTOR & LINK ASSY (SEE PAGE 66-14)

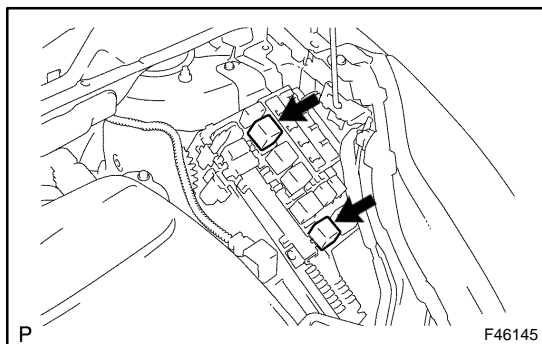

### 7. BRAKE CONTROL (ECB) OFF

#### NOTICE:

Prohibit the brake control (ECB) certainly before bleeding the brake fluid.

- (a) With the power switch off to prohibit brake control, remove the motor relays No.1 and No.2.

#### NOTICE:

If the pump motor operates while there is air remaining inside the brake actuator hose, the air will enter the actuator, resulting in difficulty in air bleeding.

#### HINT:

Brake control (ECB) can be prohibited by selecting "ECB INVALID" on the hand-held tester.

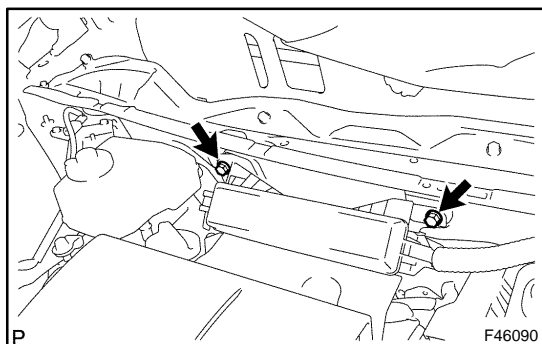

### 8. REMOVE COWL TOP PANEL SUB-ASSY OUTER FRONT

- (a) Remove the 2 bolts and separate the engine room R/B No.2.

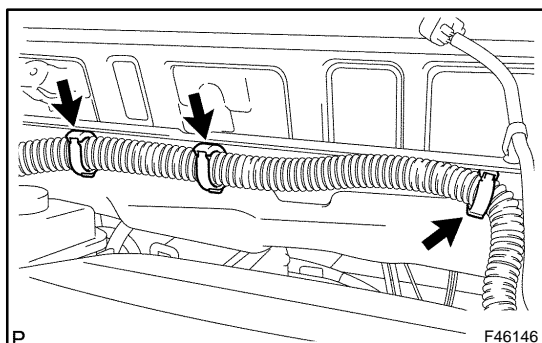

- (b) Remove the 3 clamps from the cowl top panel sub-assy outer front.

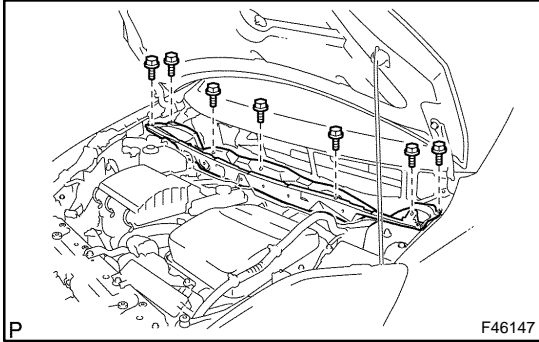

- (c) Remove the 7 bolts and separate the cowl top panel sub-assy outer front.

## 9. REMOVE W/CONVERTER INVERTER ASSY (SEE PAGE 21-23)

HINT:

Refer to the procedures from the removal of the engine undercover LH up until the removal of the inverter assy with converter.

## 10. DRAIN BRAKE FLUID

NOTICE:

Wash brake fluid off immediately if it adheres to any painted surface.

## 11. REMOVE INSTRUMENT PANEL REGISTER ASSY NO.1 (SEE PAGE 71-13)

## 12. REMOVE INSTRUMENT PANEL FINISH PANEL SUB-ASSY LOWER (SEE PAGE 71-13)

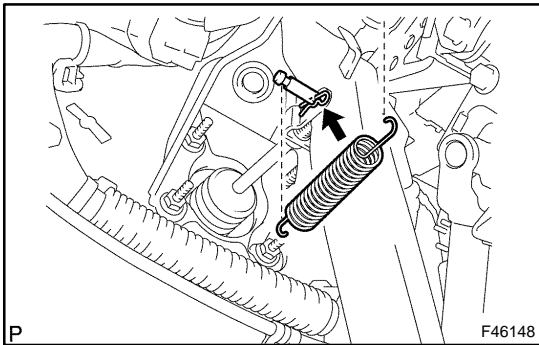

## 13. REMOVE BRAKE MASTER CYLINDER SUB-ASSY

- (a) Remove the brake return spring.  
 (b) Remove the clip and brake master cylinder push rod pin, and separate the push rod clevis from the brake pedal.

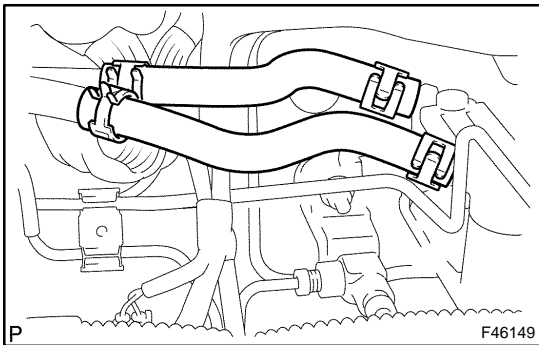

- (c) Remove the 4 clips and 2 reservoir tube hoses.

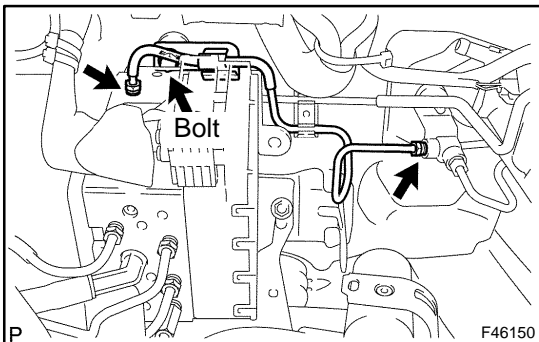

- (d) Remove the bolt from the actuator bracket.  
 (e) Using SST, remove the front brake tube No.1.  
 SST 09023-00100

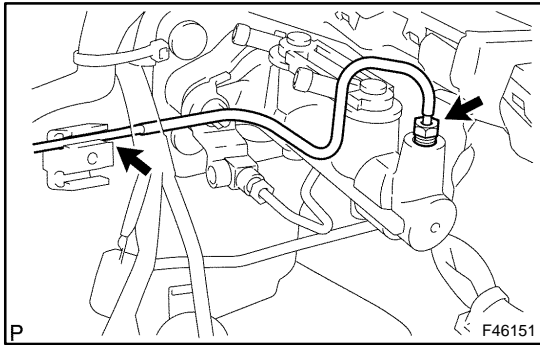

- (f) Using SST, separate the front brake tube No.2 from the clamp and brake master cylinder sub-assy.  
SST 09023-00100

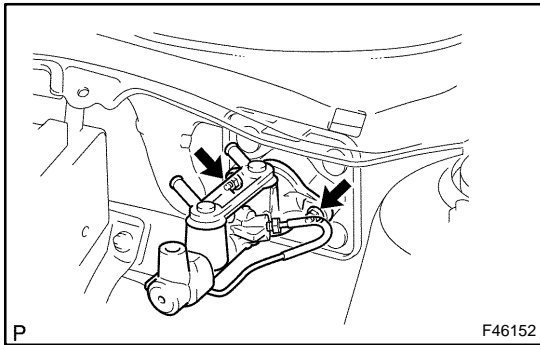

- (g) Remove the 2 nuts, and remove the brake master cylinder gasket and brake master cylinder sub-assy from the bracket.

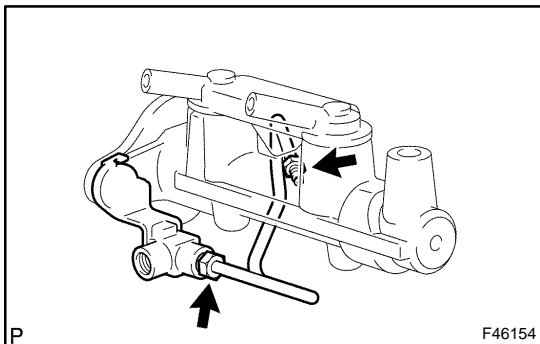

- (h) Using SST, remove the brake tube and 2 way from the brake master cylinder sub-assy.  
SST 09023-00100

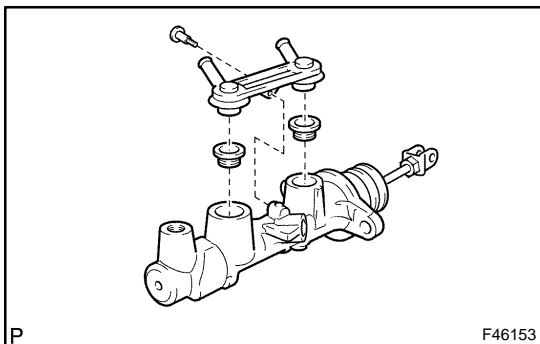

- (i) Remove the screw, and remove the brake master cylinder union No.1 and 2 grommets from the brake master cylinder sub-assy.

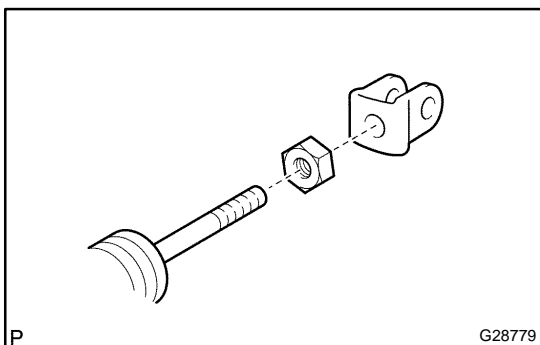

- (j) Loosen the clevis lock nut and remove the brake master cylinder push rod clevis.

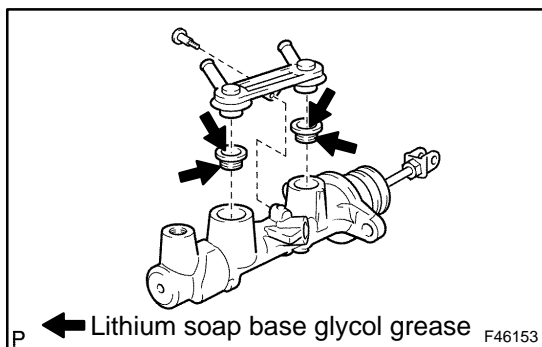
**14. INSTALL BRAKE MASTER CYLINDER SUB-ASSY**

- (a) Install the brake master cylinder push rod clevis to the brake master cylinder sub-assy, and fix by the lock nut.

**HINT:**

After adjusting the brake pedal height, torque the lock nut.

- (b) Apply lithium soap base glycol grease to the 2 new grommets.
- (c) Install the brake master cylinder union No.1 and 2 grommets to the brake master cylinder sub-assy with a screw.  
**Torque: 1.8 N·m (18 kgf·cm, 16 in.-lbf)**

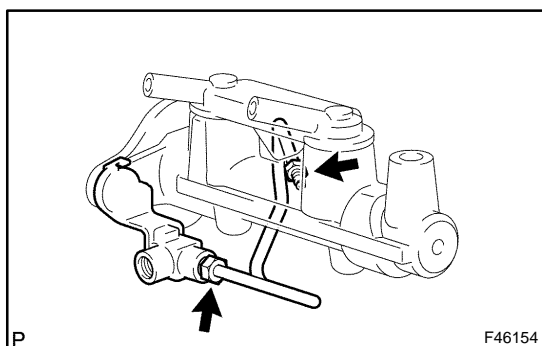

- (d) Using SST, install the brake tube and 2 way to the brake master cylinder sub-assy.

SST 09023-00100

**Torque: 15 N·m (155 kgf·cm, 11 ft.-lbf)**

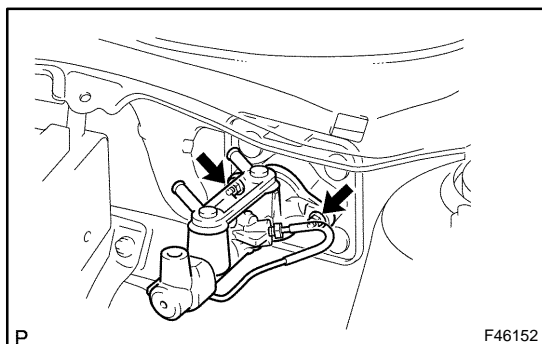

- (e) Placing the gasket in between, install the brake master cylinder sub-assy to the bracket with 2 nuts.

**Torque: 13 N·m (127 kgf·cm, 9 ft.-lbf)**

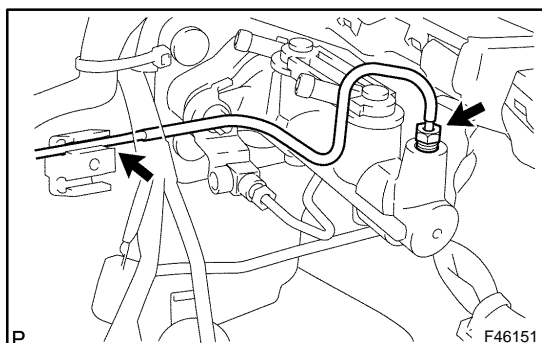

- (f) Using SST, connect the front brake tube No.2 to the clamp and brake master cylinder sub-assy.

SST 09023-00100

**Torque: 15 N·m (155 kgf·cm, 11 ft.-lbf)**

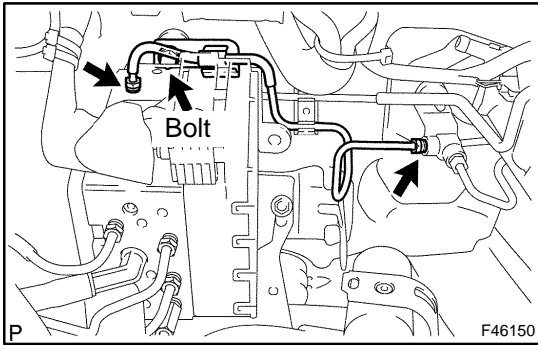

- (g) Using SST, connect the front brake tube No.1.  
SST 09023-00100  
**Torque: 15 N·m (155 kgf·cm, 11 ft·lbf)**
- (h) Install the bolt to the actuator bracket.  
**Torque: 5.0 N·m (51 kgf·cm, 44 in·lbf)**

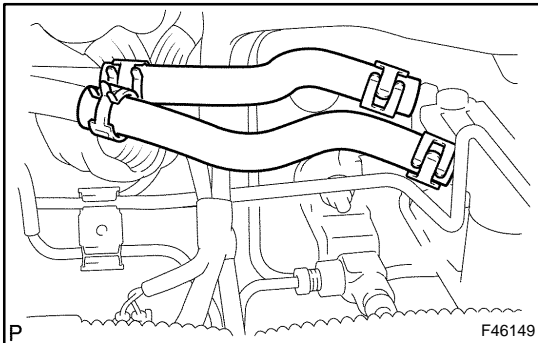

- (i) Connect the 2 reservoir tube hoses and hold them there with clips.

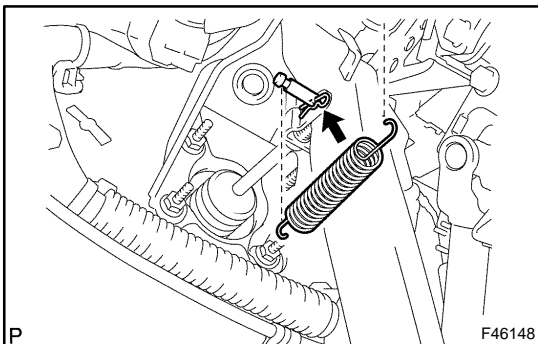

- (j) Install the push rod clevis with the brake master cylinder push rod pin to the brake pedal.
- (k) Install the clip and brake pedal return spring.

## 15. INSTALL W/CONVERTER INVERTER ASSY (SEE PAGE 21-23)

### HINT:

Refer to the procedures from the installation of the inverter assy with converter up until the installation of the engine under cover LH.

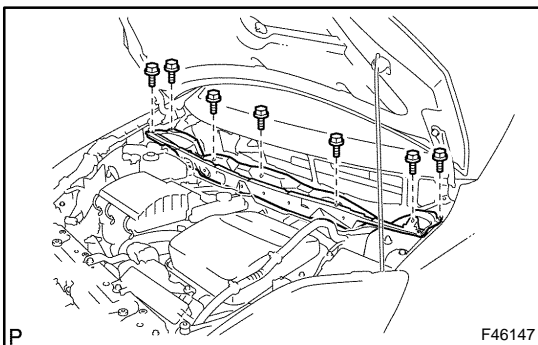

## 16. INSTALL COWL TOP PANEL SUB-ASSY OUTER FRONT

- (a) Install the cowl top panel sub-assy outer front with the 7 bolts.  
**Torque: 6.4 N·m (65 kgf·cm, 57 in·lbf)**

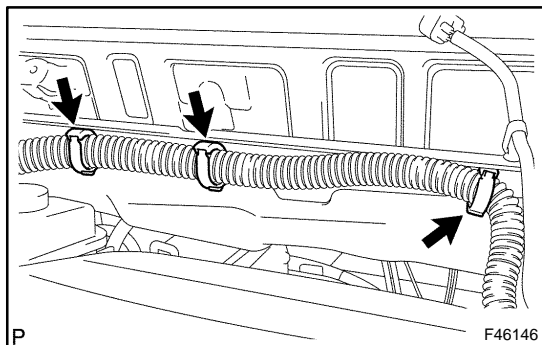

- (b) Install the 3 clamps to the cowl top panel sub-assy outer front.

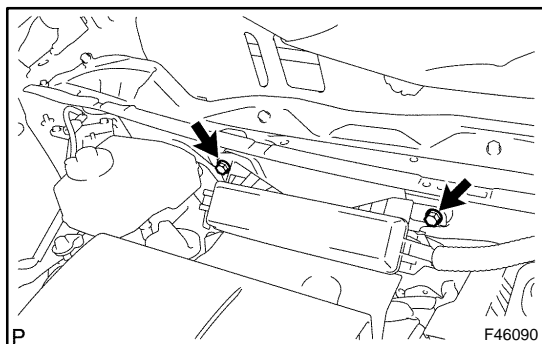

- (c) Install the engine room R/B No.2 with the 2 bolts.  
**Torque: 8.4 N·m (86 kgf·cm, 74 in·lbf)**

17. **INSTALL WINDSHIELD WIPER MOTOR & LINK ASSY (SEE PAGE 66-14)**
18. **INSTALL FR WIPER ARM LH (SEE PAGE 66-14)**
19. **INSTALL FR WIPER ARM RH (SEE PAGE 66-14)**
20. **FILL RESERVOIR WITH BRAKE FLUID (SEE PAGE 32-4)**
21. **BLEED MASTER CYLINDER (SEE PAGE 32-4)**  
SST 09023-00100
22. **BLEED MASTER CYLINDER /STROKE SIMULATOR (SEE PAGE 32-4)**
23. **CHECK BRAKE FLUID LEAKAGE**
24. **CHECK FLUID LEVEL IN RESERVOIR**
25. **CHECK AND ADJUST BRAKE PEDAL HEIGHT (SEE PAGE 32-16)**
26. **CHECK PEDAL FREE PLAY (SEE PAGE 32-16)**
27. **CHECK PEDAL RESERVE DISTANCE (SEE PAGE 32-16)**
28. **INSTALL INSTRUMENT PANEL FINISH PANEL SUB-ASSY LOWER**
29. **INSTALL INSTRUMENT PANEL REGISTER ASSY NO.1**
30. **CHECK AND CLEAR DTC (SEE PAGE 05-973)**